

YEFB Hydro Blower

2 & 4 pipe system

A complete range from 4.3 kW up to 28.9 kW



CSR00 (Wall mounted)
Fan speed selector



CMR00 (Wall mounted)
Thermostat with manual fan speed and S/W change over



CER00 (Wall mounted)
Thermostat with manual fan speed and automatic change over

CER20 (Wall mounted)
Thermostat with auto. fan speed and automatic change over

CER30 (Wall mounted)
Thermostat with auto. fan speed and automatic change over for modulating valve



TUC03+ Terminal unit controller
BacNET and N2 Metasys network compatible



YEFB Blower units are available in 6 sizes for horizontal concealed installations: thanks to their high ESP fans that can handle up to 250Pa, they are the ideal solution for air conditioning large spaces.



Selection software

Features

- 6 unit sizes for horizontal mounting
- Handles high external static pressure up to 250Pa
- Choice of 2 or 4 pipe systems
- Twin centrifugal fans
- Horizontal air return
- Air distribution plenum
- Electric heater option
- Optional paint finish
- F5 grade filter option
- 5 Row cooling coil option on sizes 060, 070
- EUROVENT Certified

YEFB Hydro Blower

4.3 to 28.9 kW



Unit performance at different Pa external static pressure, with 4 row cooling coil

Model YEFB		020-4	030-4	040-4	050-4	060-4	070-4*	
Total cooling capacity [kW]	(1)	max	6.95	9.49	11.77	13.72	23.83	28.99
		med	5.90	8.23	10.35	12.6	21.59	26.64
		min	4.30	7.11	8.91	11.36	17.15	24.28
Sensible cooling capacity [kW]	(1)	max	4.99	7.91	9.94	11.80	18.89	23.75
		med	4.14	6.7	8.61	10.60	16.84	21.50
		min	2.98	5.68	7.17	9.44	12.93	19.14
Water flow in cooling [l/h]	(1)	max	1195	1632	2024	2360	4099	4974
		med	1015	1416	1780	2167	3714	4571
		min	740	1223	1533	1954	2950	4167
Pressure drop in cooling [kPa]	(1)	max	17.4	31.5	30.6	40.4	28.0	39.2
		med	12.2	24.1	23.3	33.8	23.2	33.1
		min	6.5	18.4	17.9	28.3	15.1	28.2
Heating capacity 2 pipes [kW]	(2)	max	7.08	11.40	14.32	17.4	28.08	35.01
		med	6.20	9.62	12.19	15.53	24.95	32.16
		min	4.55	8.20	10.4	13.85	18.9	28.84
Water flow in heating 2 pipes [l/h]	(2)	max	1219	1962	2465	2727	4495	5555
		med	1067	1656	2098	2673	4034	4926
		min	783	1411	1788	2392	3047	4330
Pressure drop in heating 2 pipes [kPa]	(2)	max	13.3	34.0	36.1	51.0	30.2	47.2
		med	10.3	25.7	26.9	41.3	23.5	40.3
		min	4.8	19.2	20.0	33.4	14.6	32.8
Heating capacity 2 pipes [kW]	(3)	max	13.49	19.31	30.3	28.47	49.17	60.88
		med	9.8	14.51	22.93	24.81	41.75	55.4
		min	5.87	12.66	18.12	21.99	32.27	50.21
Water flow in heating 2 pipes [l/h]	(3)	max	1177	1688	2638	2492	4287	5305
		med	854	1266	1994	2169	3639	4827
		min	510	1104	1574	1921	2813	4374
Pressure drop in heating 2 pipes [kPa]	(3)	max	12.3	23.2	43.4	31.2	23.9	38.5
		med	7.1	14	26.5	24.5	17.9	32.6
		min	2.9	11.0	17.6	19.8	11.4	27.4
Air flow [m ³ /h]		max	1145	1910	2680	3250	4120	5493
		med	920	1520	2130	2870	3610	4926
		min	620	1205	1655	2470	2580	4330
Sound power level [dB(A)]		max	64.0	65.0	69.0	72.0	77.0	79.0
		med	58.0	61.0	63.0	68.0	74.0	76.9
		min	48.0	57.0	57.0	65.0	65.1	74.4
Sound pressure level [dB(A)]	(4)	max	53.0	54.0	58.0	61.0	66.0	67.0
		med	47.0	50.0	52.0	57.0	63.0	65.0
		min	37.0	46.0	46.0	54.0	54.0	63.0
Power supply [V-ph-Hz]		230 / 1 / 50						
Power input [W]	max	171	352	451	588	1007	1 767	
Absorbed current [A]	max	0.74	1.62	2.05	2.83	4.47	8.08	
Dimensions	Height	mm	407.6	407.6	407.6	407.6	517.6	517.6
	Width	mm	902	902	902	902	1 160	1 160
	Depth	mm	989.6	989.6	1 239.6	1 239.6	1 634.6	1 634.6

(1) Room temperature 27°C d.b., 19°C w.b. - Water temperature 7/12 °C
 (2) Room temperature 20°C - Water inlet temperature: 45/40°C
 (3) Room temperature 20°C - Water inlet temperature: 65/55°C at 50 Pascal ESP
 (4) Sound pressure level in a 100 m³ room, at 1 m distance and reverberating time of 0.3 s.
 4 pipe system not available with 4R heating coil
 * Performances are out of scope Eurovent FCP.



Manufacturer reserves the rights to change specifications without prior notice.

YEFB Hydro Blower

Compatibility tables



Compatibility Options / Accessories / Models

Code	Designation	YEFB					
		020	030	040	050	060	070
Coils and heaters**							
BA2**	Additional 2 row heating	•	•	•	•	•	•
BA3**	Additional 3 row heating	•	•	•	•	•	•
KREL**	Kit electrical heater with safety thermostat and relay	•	•	•	•	•	•
Factory fitted electric box							
CBL10	Transformer 230/24V	•	•	•	•	•	•
CBL20	Parallel connection for ON/OFF valve	•	•	•	•	•	•
CBL30	Parallel connection for modulating valve	•	•	•	•	•	•
Remote controllers and thermostats (wall mounted)							
CSR00	Fan speed selector (wall mounted)	•	•	•	•	•	•
CMR00	Thermostat with manual fan speed and S/W change over	•	•	•	•	•	•
CER00	Thermostat with manual fan speed, dead band, automatic change over	Compatible with electrical heaters					
CER20	Thermostat with automatic fan speed, dead band, automatic change over	Compatible with electrical heaters					
CER30	Thermostat with automatic fan speed, dead band, automatic change over for modulating valves	•	•	•	•	•	•
OPT10+OC716	Omnibus control for YEFB units + Remote Analogue Plus	•	•	•	•	•	•
OPT10+OC216	Omnibus control for YEFB units + Remote Display console	•	•	•	•	•	•
Valves (Supplied loose) / Condensate pump / Water sensor (Factory fitted)							
J3B2 (2p)	3-way 4-ports on/off valves for 2-pipe systems	•	•	•	•		
J3B2 (4p)	3-way 4-ports on/off valves for 4-pipe systems	•	•	•	•		
J3C2 (2p)	3-way 4-ports on/off valves for 2-pipe systems					•	•
J3C2 (4p)	3-way 4-ports on/off valves for 4-pipe systems					•	•
J3BM (2p)	3-way 4-ports modulating valves for 2-pipe systems	•	•	•	•		
J3BM (4p)	3-way 4-ports modulating valves for 4-pipe systems	•	•	•	•		
J3CM (2p)	3-way 4-ports modulating valves for 2-pipe systems					•	•
J3CM (4p)	3-way 4-ports modulating valves for 4-pipe systems					•	•
DT (2p)	Shut-off valves for 2-pipe systems supplied loose in addition to J3B2 and J3BM valves (in addition to J3A2/J3AM valves)	•	•	•	•	•	•
DT (4p)	Shut-off valves for 4-pipe systems (in addition to J3A2/J3AM valves)	•	•	•	•	•	•
PC	Condensate pump	•	•	•	•	•	•
WS	Water sensor	Compatible with CEL/CER					
External air intake							
PAS	Air intake plenum collars	•	•	•	•	•	•
PM	Air delivery plenum with collars	•	•	•	•	•	•
PM + Grill	Air delivery plenum painted with air outlet grill	•	•	•	•	•	•

- Compatible
- ◻ Compatible with conditions
- ◻ Not compatible

** Maximum of rows is indicated in the documentation, the maximum number of rows includes the heating row or electrical heater.

Dimensions & Weights

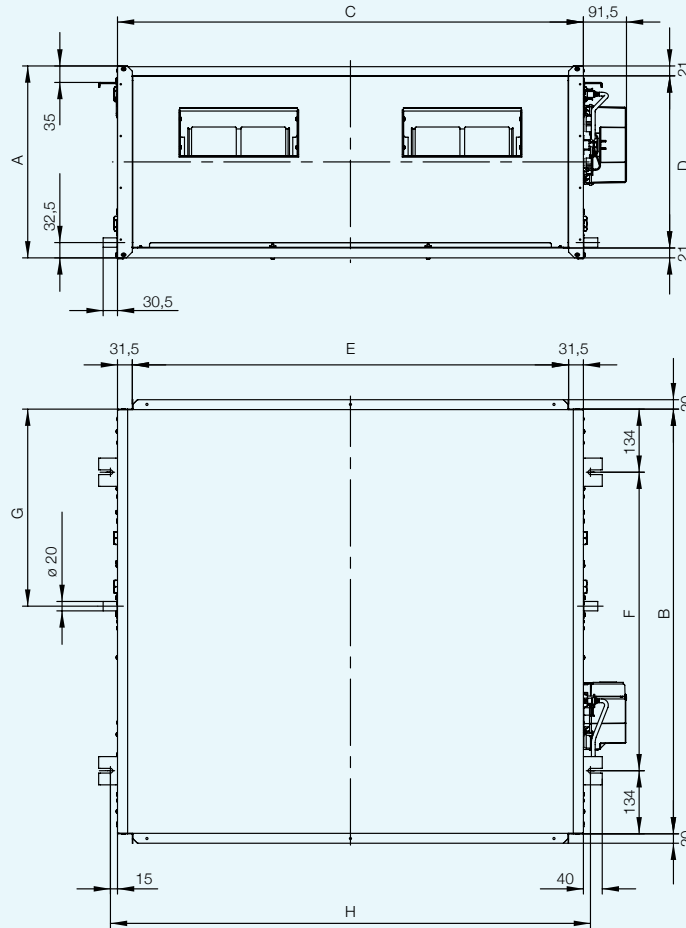

Model YEFB		020-4	030-4	040-4	050-4	060-4	070-4
A	min	407.6	407.6	407.6	407.6	517.6	517.6
B	mm	902	902	902	902	1160	1160
C	mm	989.6	989.6	1239.6	1239.6	1634.6	1634.6
D	min	365.6	365.6	365.6	365.6	475.6	475.6
E	mm	926.6	926.6	1176.6	1176.6	1571.6	1571.6
F	min	634	634	634	634	892	892
G	mm	418.5	418.5	418.5	418.5	446.5	446.5
H	mm	1019.6	1019.6	1269.6	1269.6	1664.6	1664.6
Weight (3R - 3 rows)	kg	64.3	64.3	79.3	79.3	126.0	126.0
		(2-3-4 rows)	(2-3-4 rows)	(2-3-4 rows)	(2-3-4 rows)	(2-3-4-5 rows)	(2-3-4-5 rows)
Weight of the coil	kg	1.2 - 2.0 - 2.6	1.2 - 2.0 - 2.6	1.9 - 2.9 - 3.7	1.9 - 2.9 - 3.7	3.4 - 4.6 - 6.3 - 9.0	3.4 - 4.6 - 6.3 - 9.0
Water connection		G1/2" F	G1/2" F	G1/2" F	G1/2" F	G1" M	G1" M
		(2-3-4 rows)	(2-3-4 rows)	(2-3-4 rows)	(2-3-4 rows)	(2-3-4-5 rows)	(2-3-4-5 rows)
Water content	l	1.4 - 2.2 - 2.9	1.4 - 2.2 - 2.9	1.9 - 2.8 - 3.8	1.9 - 2.8 - 3.8	3.4 - 5.0 - 6.7 - 8.4	3.4 - 5.0 - 6.7 - 8.4